



24255 Pacific Coast Hwy  
Malibu, California, 90263  
310-506-1147  
[www.villagraziadio.com](http://www.villagraziadio.com)

---

The executive conference center located on the campus of Pepperdine University in Malibu is available to host manager retreats, sales training meetings, or seminars.

Villa Graziadio's 45,000 square feet of meeting space includes two tiered amphitheatres (seating for 40 and 180 respectively) with video conferencing capabilities. All 20 individual meeting rooms come equipped with ergonomically designed chairs, T1 Ethernet capacity, wireless connectivity, and LCD projection with drop down screens. The Villa's two executive board rooms feature 42" plasma screens with electronic white boards and leather high backed chairs. Villa Graziadio can accommodate most data training needs in a fully equipped computer training room featuring 24 computers with 18" plasma screens. After a hard day of work, relax in one of the 50 well appointed guest rooms with 480 thread count sheets, flat screen TVs, and a peaceful view of the Pacific Ocean which can only be experienced from the mountains of Malibu.

A Complete Meeting Package (CMP) includes meeting space, LCD projection, high-speed Internet access, hot breakfast, continuous morning and afternoon break service featuring Starbucks® coffee, lunch and dinner.

A Day Meeting Package (DMP) includes meeting space, LCD projection, high-speed Internet access, continental breakfast, continuous morning and afternoon break service, and lunch. For more information and pricing, please visit the Villa's Web site at [www.villagraziadio.com](http://www.villagraziadio.com) or call the sales office at 310-506-1147.

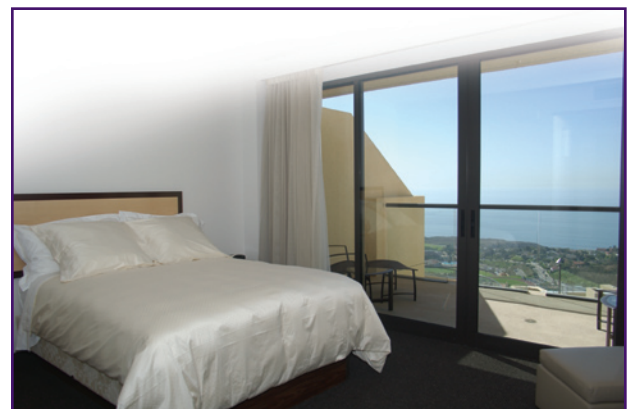

Please ask about the Villa's Westside Conference Center at [www.westsideconferencecenter.com](http://www.westsideconferencecenter.com)

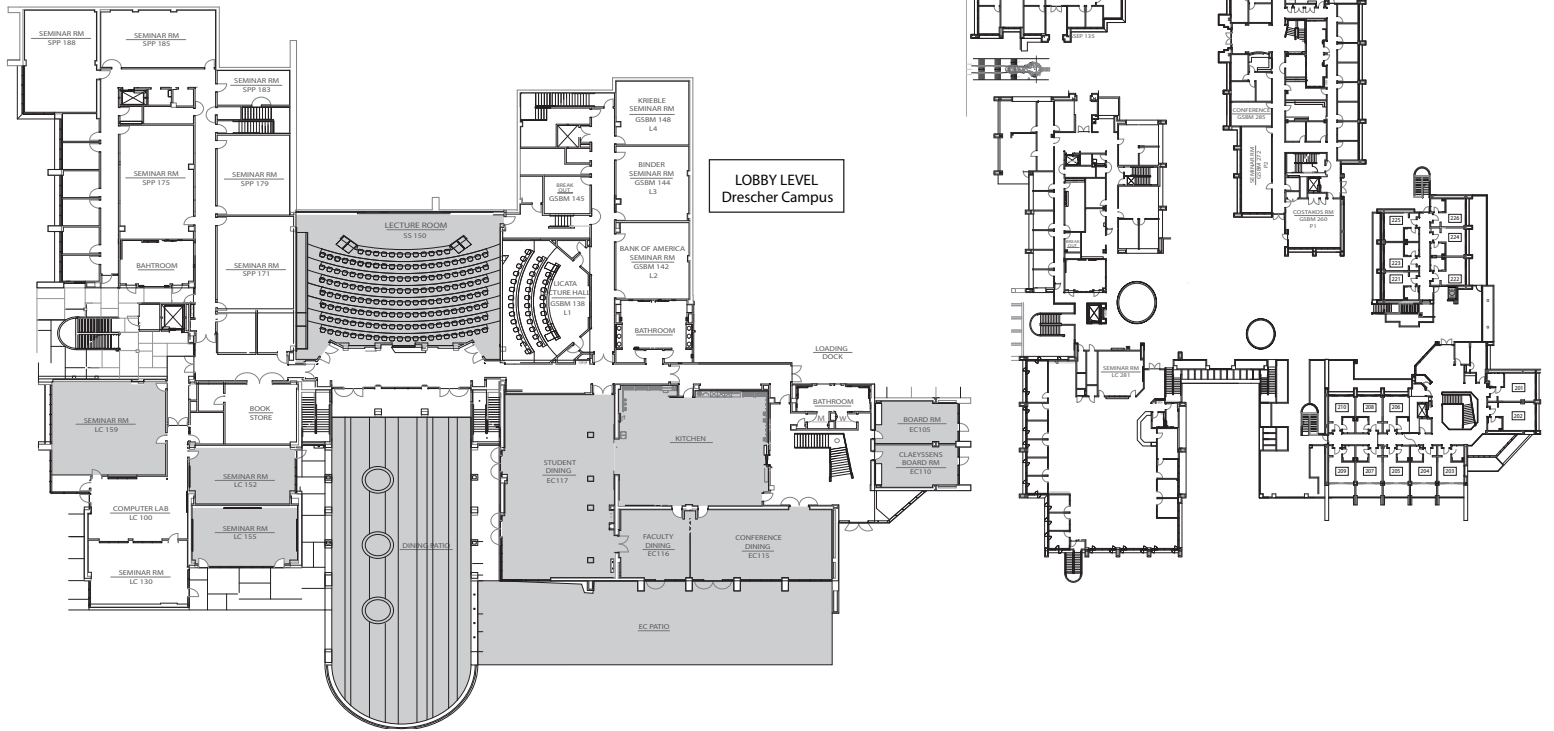

ROOM NAME	LENGTH	WIDTH	HEIGHT	SQUARE FT	BQTR10	BQTR 8	CLASS	CONFST	H/S	U SHAPE
EC 116 Fac Dining Room	25	21.5	9	537.5	40	32	~	~	~	~
EC 105 Board Room	26	15	9	390	~	~	~	14	~	~
Clayssens Board Room	26	15	9	390	~	~	~	14	~	~
EC 115 Exec Dining Room	44	25	9	1100	80	64	~	~	~	~
Margaret M. Rockwell Dining	66	34	9	2244	140	112	~	~	50	44
EC 115/116/117 All Dining	0	0	0	0	260	208	~	~	~	~
EC 115/116 Full Dining Room	69	46.5	9	3208.5	120	96	~	~	~	~
EC Outside Lobby	0	0	0	0	~	~	~	~	~	~
LC 100 Computer Lab	37	29	9	1073	~	~	24	~	~	~
LC 159 Seminar Room	35	35	9	1225	~	~	50	~	38	30
LC 152 Seminar Room	32	16	9	512	~	~	~	~	~	~
LC 130 Seminar Room	29	23	9	667	~	~	24	~	~	~
LC 155 Seminar Room	32	23	9	736	~	~	32	20	24	20
LC 282 Library Seminar Room	24	22	9	528	~	~	28	16	24	20
Patio Executive Center Dining	70	50	0	3500	~	40	~	~	~	~
Licata Lecture Hall (L1)	44	25	12	1100	~	42	~	~	~	~
Bank of America Seminar (L2)	27.5	22.5	9	618.75	~	~	28	~	24	20
Patio Student Dining	65	90	0	5850	~	80	~	~	~	~
Binder Seminar Room (L3)	27.5	22.5	9	618.75	~	~	28	22	24	20
SBM 272 Seminar Room (P2)	44	16	9	704	~	~	32	28	32	30
SBM 285 Plaza Conference Room	26	16	9	416	~	~	~	10	~	~
SBM 300 Seminar Room (U3)	36	22	9	792	~	~	30	22	24	20
SBM 368 Dean's Conference	26	16	9	416	~	~	~	14	~	~
SBM 380 Seminar Room (U1)	24	22	9	528	~	~	28	22	24	20
SBM 390 Seminar Room (U2)	22	13	9	286	~	~	30	22	24	20
SEP 160 Seminar Room	34.5	24.5	9	845.25	~	~	30	20	30	24
SEP 180 Seminar Room	34.5	24.5	9	845.25	~	~	30	20	30	24
SEP 160/180 Full Seminar Room	69	49	9	3381	~	~	72	40	50	44
SPP 100 Seminar Room	34	20	9	680	~	~	30	22	30	~
SBM 145 Break Out Room	13.5	14	9	189	~	~	~	8	~	~
Kimble Seminar Room (L4)	23.5	22.5	9	528.75	~	~	24	16	20	18
Costakos Seminar Room (P1)	29	24	9	696	~	~	32	24	32	28
SPP 183 Seminar Room	28.5	12.5	9	356.25	~	~	~	8	~	~
SPP 174 Seminar Room	31.5	28.5	9	897.75	~	~	28	16	24	20
SPP 175 Seminar Room	41	37	9	1517	~	~	50	32	40	36
SPP 171 Seminar Room	38	34	9	1292	~	~	30	22	28	24
SPP 188 Seminar Room	36	21	9	756	~	~	30	22	28	24
SS 150 Tiered Classroom	60	52.5	12	3150	~	~	180	~	~	~
TOTAL MEETING SPACE				42097.75						